

Adhunik Poshak Shilpa Ltd.

Kazipur Fashion Ltd.

Tip Tip Fashion Ltd.

Crazy Fashion Ltd.

Wear Mag Ltd.

Avenue-1, Industrial plot-1, Block-E, Section-11, Mirpur, Dhaka.

(23.82170N, 90.37470E)

25 June 2014



Observations

Areas of high loading observed

High storage loads on level 5 and 3



Heavy storage observed on several floors. Punching shear of the flat slab is a concern

Rolls of fabric stored on production/sewing floors

Inconstancies between documentation and as built construction

An additional lift shaft was provided in the western shear core which was not observed on the structural drawings.

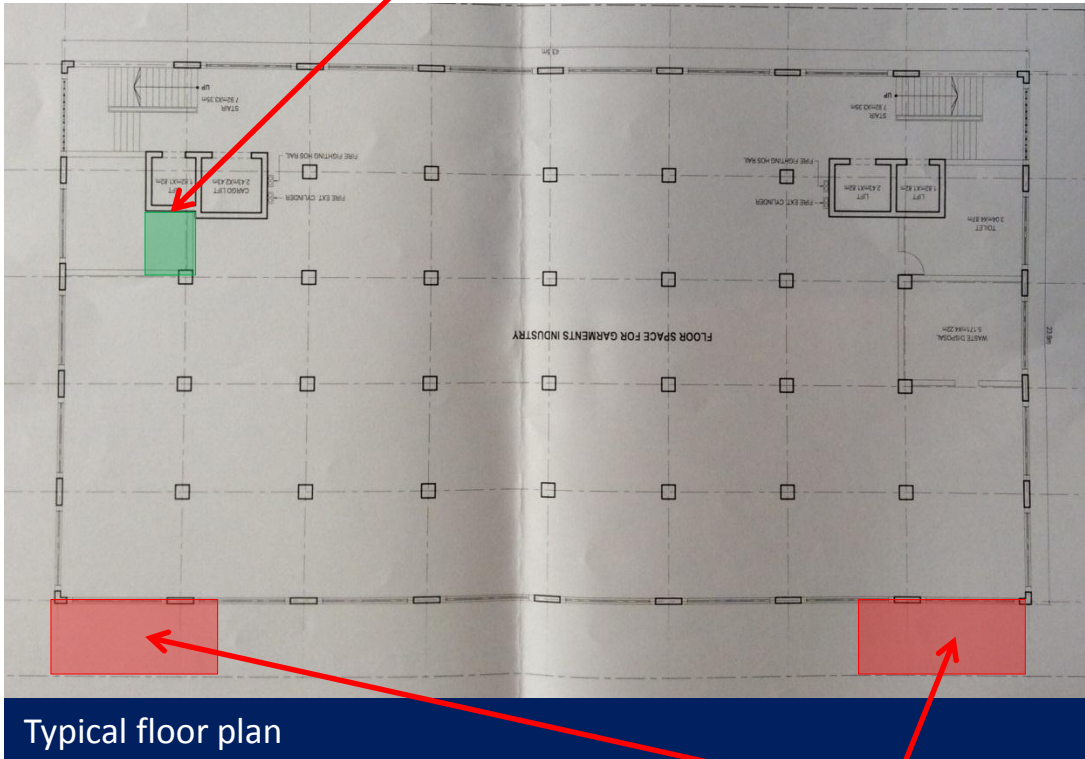

Two additional escape stair cases were provided to the building on the southern elevation. These stairs had their own supporting columns which were not observed on the floor plans.

Priority Actions

Problems Observed

- ITEM 1:** Areas of high loading observed
- ITEM 2:** High column stresses for two water tank columns
- ITEM 3:** Inconstancies between documentation and as built construction

Item No.	Observation	Recommended Action Plan	Recommended Timeline
1	Areas of high loading observed	Produce and actively manage a loading plan for all floor plates within the factory giving consideration to floor slab and column capacity	6-months
2	Relatively high working stress in columns supporting water tanks and toilet blocks	Building engineer to review design, load and column stresses in the area identified above.	6-months
3	Relatively high working stress in columns supporting water tanks and toilet blocks	Verify insitu concrete stresses by existing cylinder strength for the identified columns above or 100mm dia. cores from 4 columns.	6-months
4	Relatively high working stress in columns supporting water tanks and toilet blocks	Produce and actively manage a loading plan for all floor plates within the factory giving consideration to floor capacity and column capacity	6-months
5	Inconstancies between documentation and as built construction	Building engineer to check, collect information and produce accurate and complete as-built documentation	6-months