

# ABSS High Tech Sweater Ltd.

Kalameshar, Board Bazar, Gazipur

(23.942423,90.383163)

10 May, 2016

## Client Summary Report





# Observations



# Improper documentation

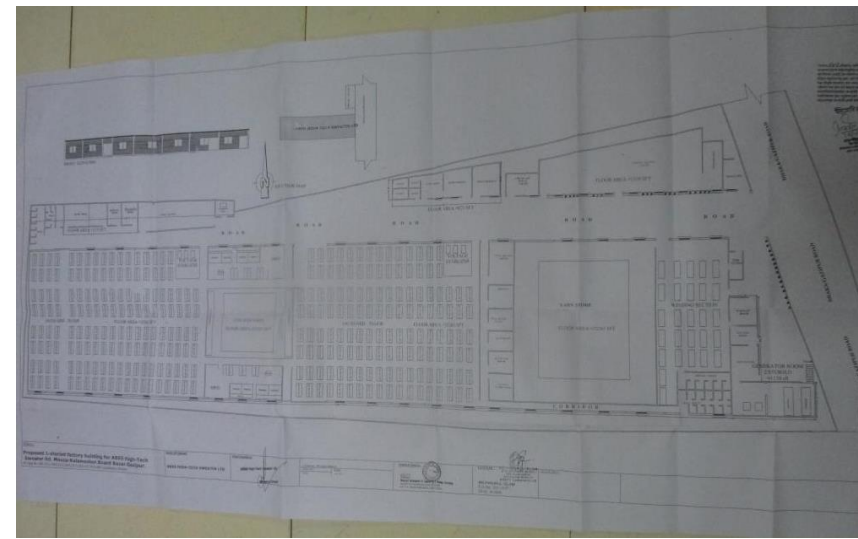
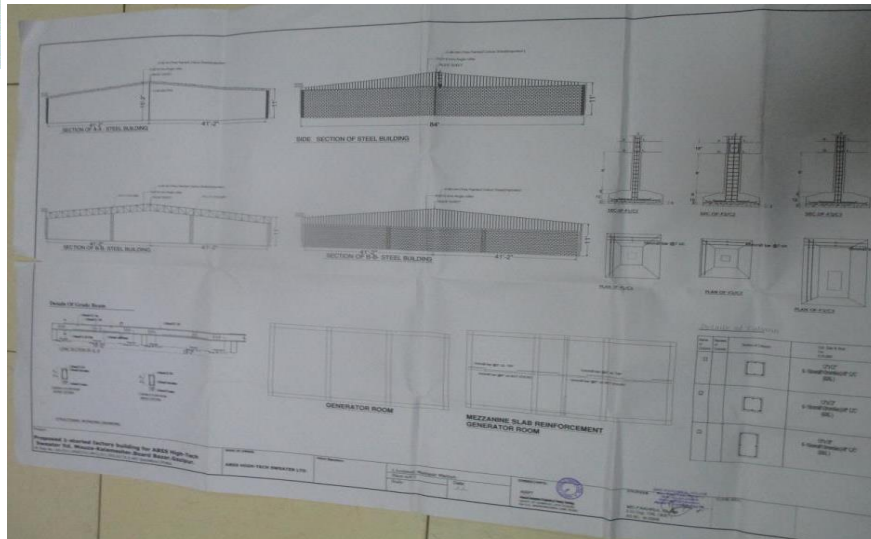

Factory showed us sets of permit drawings from local authority and Industrial inspection Authority of Bangladesh. These drawings only shows layout plan for whole compound but structural drawing not shown. A full set of as-built drawing to be prepared showing detail arrangement of structural members.



# Stability check for Non-engineered steel roof against lateral load





Steel shed appears to be non-engineered (no apparent lateral stability system, apparently non engineered connections)



# Test Carried out



## Aggregate type and rebar checking





# Problems Observed

**Item 1: Improper documentation**

**Item 2: Stability check for Non-engineered steel roof against lateral load**



# Item 1 and actions

## Improper documentation

### Priority 1

(Immediate - Now)

- None required

### Priority 2

(within 6-weeks)

- Building engineer to check, collect information and produce accurate and complete as-built documentation.

### Priority 3

(within 6-months)

- None required



# Item 2 and actions

## Stability check for Non-engineered steel roof against lateral load

### Priority 1

(Immediate - Now)

- None required

### Priority 2

(within 6-weeks)

- The Building Engineer shall provide calculations showing the structural adequacy of non-engineered steel shed against lateral force

### Priority 3

(within 6-months)

- None required



# Survey Limitations and Assumptions

This report is for the private and confidential use of Accord for whom it was prepared together with their professional advisors as appropriate. It should not be reproduced in whole or in part or relied upon by third parties for any use without the express written permission of ACCORD.

This report can be used in discussion with the supplier or factory owner as a means to rectify or address any observations made. The report is not comprehensive and is limited to what could be observed during a visual inspection of the building.

This Report is not intended to be treated as a generalised inspection and does not cover the deterioration of structural members through dampness, fungal or insect attack, nor does it deal with problems and defects of a non-structural nature. Other non structural aspects of the building such as fire safety have not been assessed in this survey.

Except as otherwise noted, drains and other services were not viewed or tested during our inspection and are therefore similarly excluded from this Report. We have not inspected any parts of the structure which are covered, unexposed or inaccessible and we are therefore unable to report that any such part of the property is free from defect.

External inspection of the façade walls has generally been carried out from ground level only by visual sighting. No opening up works were carried out (except as noted) and we rely on the Architects and Engineers drawings provided to us for our views on concealed parts of the structure and in particular foundations. Strengths of materials and components are untested and we recommend that the factory owners Building Engineer carries out in-situ testing over and above those suggested to satisfy themselves with the material strengths and component details.

Recommendations, where given, are for the purpose of providing indicative advice only, are not exhaustive, relate solely to identifying key and obvious structural defects as identified in this presentation, and do not take the form of or constitute a specification for works. We take no responsibility for the works as constructed. This report does not interfere with the factory owners Building Engineers responsibility for the structural performance of this building, The Building Engineer remains fully responsible for the structural adequacy of the building.

This report does not comment in detail on the future seismic performance of the building and only highlights the fact that the building may experience significant damage or collapse in a seismic event along with many others in the Dhaka region.

The observations in this report are based on the Engineering Judgement of the lead surveyor/engineer at the time of the survey. We assume in making these observations that no covering up of faults defects, filling or plastering over cracking or significant repair work has been carried out by the building owner. Any future alteration or additional work by the building owner will void this report.